



Wiring Maury High School

Sarab Ahluwalia

Basement

Key:

Red Lines: Indicate Longest and Shortest Runs

Blue X: Indicates Equipment Room

95 Meters Width / 10 inches diagram width = **~9.5 meters/inch**

Longest Run = 75m (67m run + 6m to and from ceiling + 2m to router)

Shortest Run = 8m (6m to and from ceiling + 2m to router)

21 Rooms x 41.5m (Average Cable Length) x 2 (2 outlets per room)

Total Cable: 1744 Meters

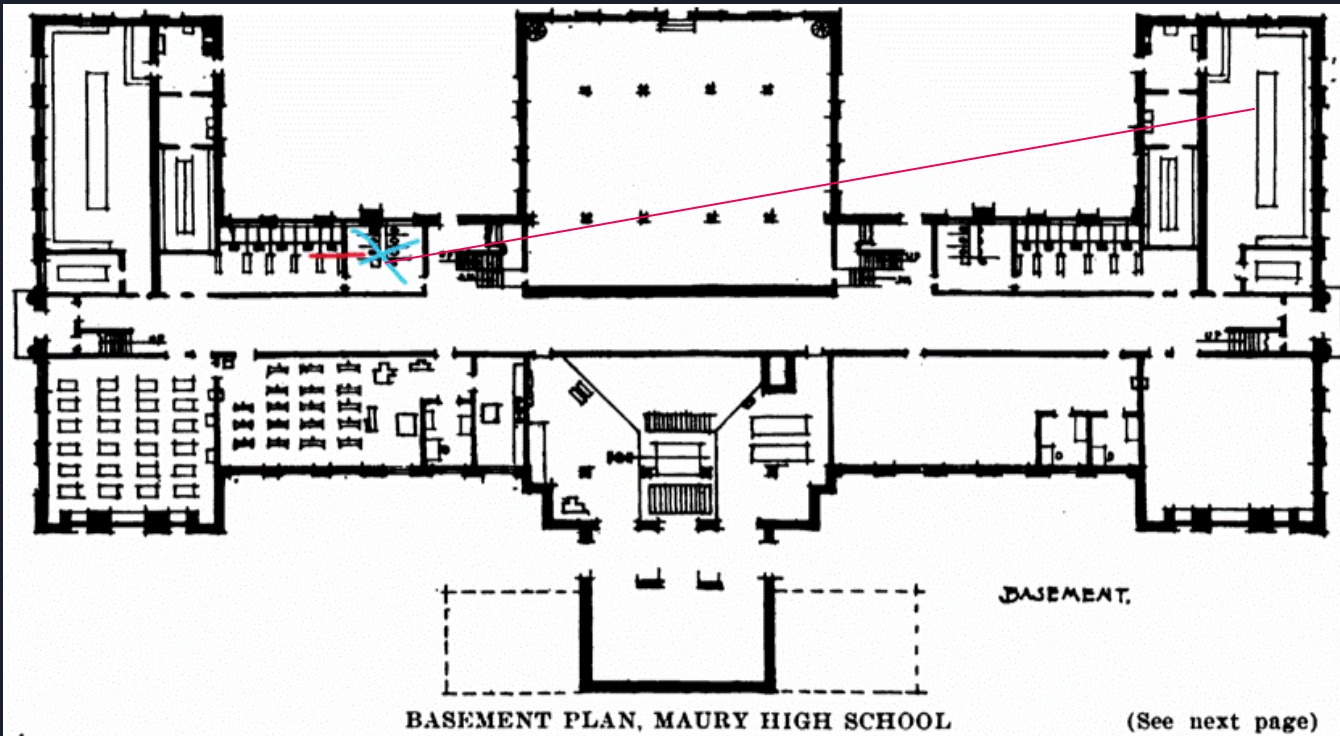

First Floor

Key:

Red Lines: Indicate Longest and Shortest Runs

Blue X: Indicates Equipment Room

95 Meters Width / 10 inches diagram width = **~9.5 meters/inch**

Longest Run = 75m (67m run + 6m to and from ceiling + 2m to router)

Shortest Run = 18m (10m run + 6m to and from ceiling + 2m to router)

17 Rooms x 46.5m (Average Cable Length) x 2 (2 Wires/room)

Total Cable: 1581 Meters

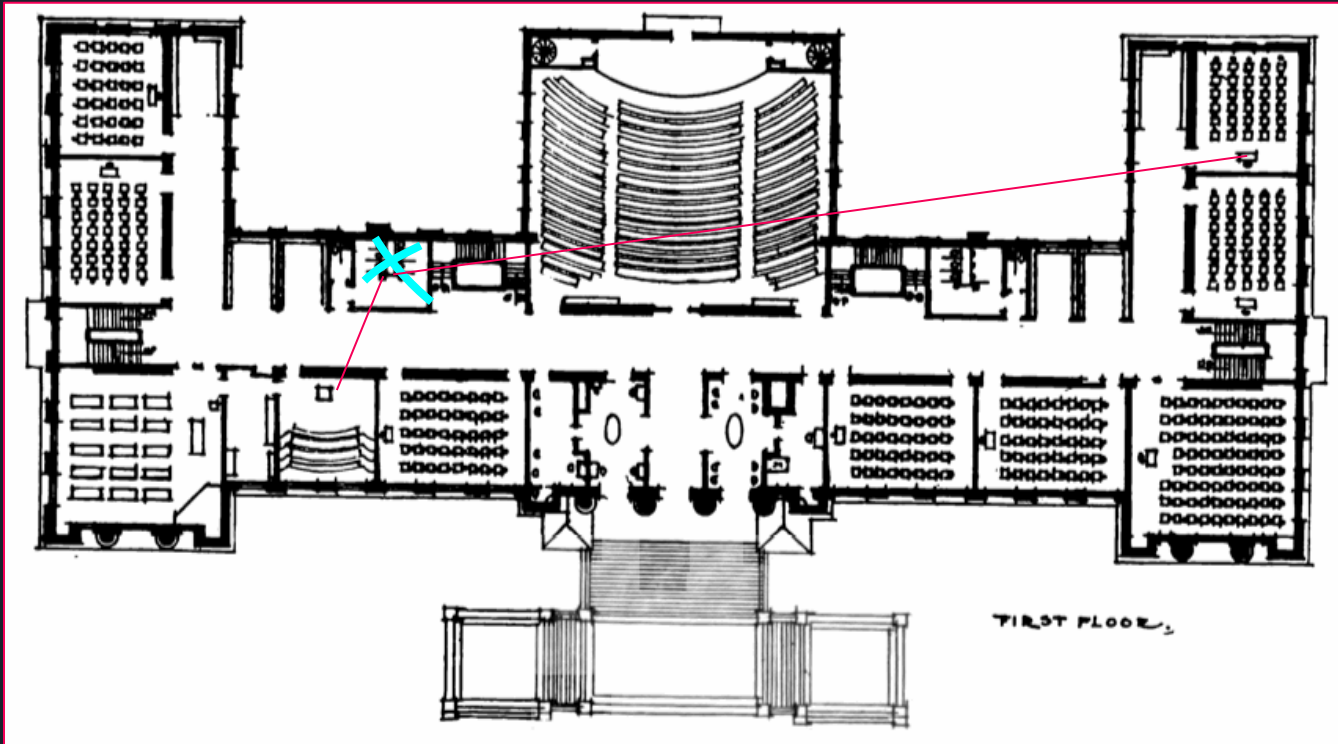

Second Floor

Key:

Red Lines: Indicate Longest and Shortest Runs

Blue X: Indicates Equipment Room

95 Meters Width / 10 inches diagram width = **~9.5 meters/inch**

Longest Run = 75m (67m run + 6m to and from ceiling + 2m to router)

Shortest Run = 18m (10m run + 6m to and from ceiling + 2m to router)

15 Rooms x 41.5m (Average Cable Length) x 2 (2 Wires/room)

Total Cable: 1245 Meters

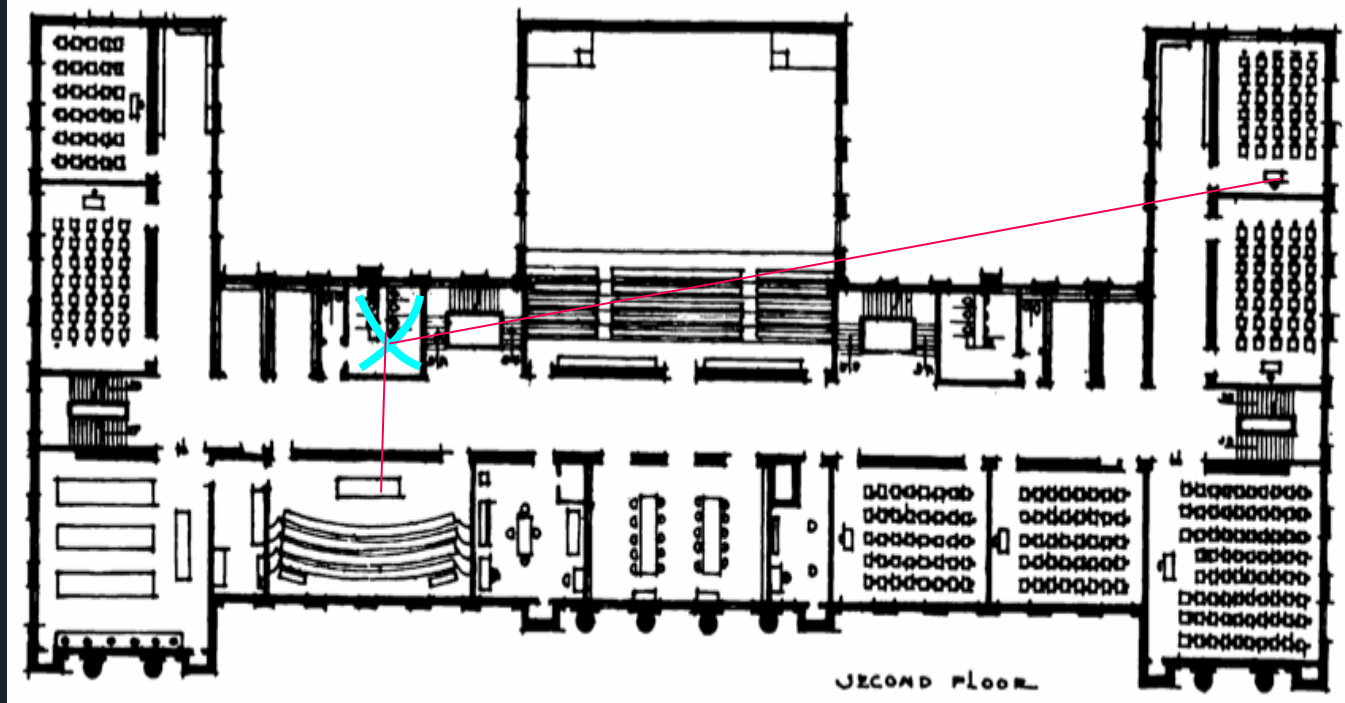

Third Floor

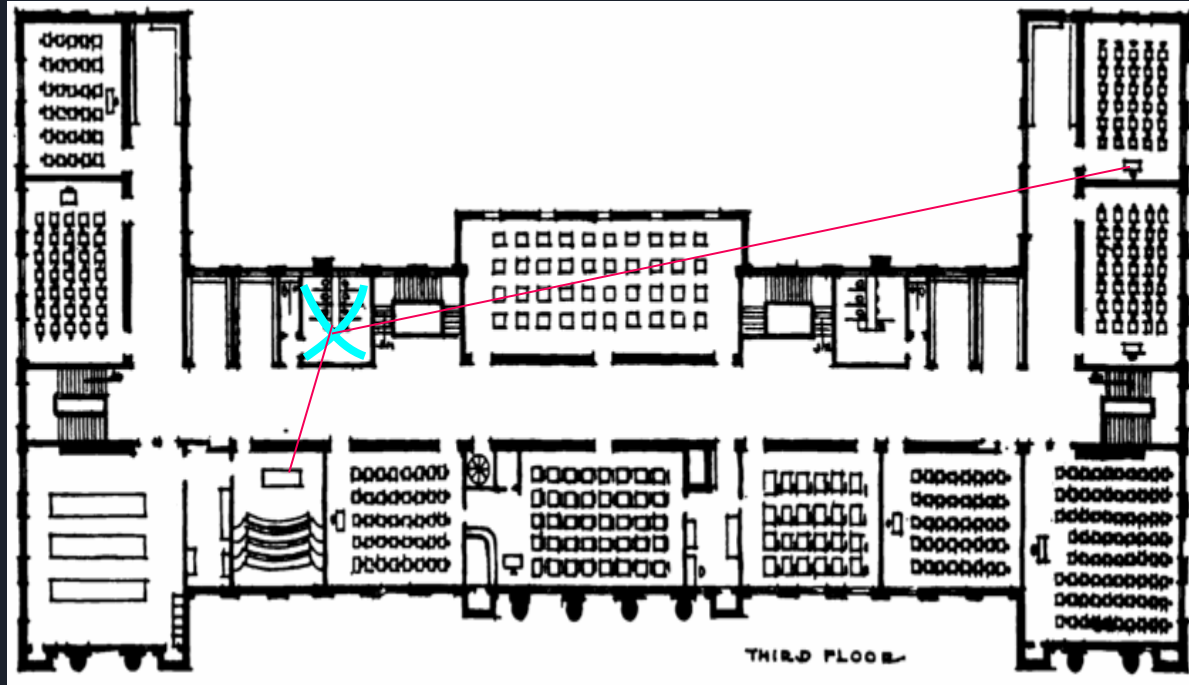

Key:

Red Lines: Indicate Longest and Shortest Runs

Blue X: Indicates Equipment Room

95 Meters Width / 10 inches diagram width = **~9.5 meters/inch**

Longest Run = 70m (62m run + 6m to and from ceiling + 2m to router)

Shortest Run = 18m (6m to and from ceiling + 2m to router)

14 Rooms x 44m (Average Cable Length) x 2 (2 wires/room)

Total Cable: 1232 Meters

Wiring Budget

	Patch Panels	Managed Switch	Cable	Outlet Faces	Firewall
Material Link	https://www.amazon.com/TRENDnet-Unshielded-Connectors-Color-Coded-TC-P24C5E/dp/B00008AWL3	https://www.amazon.com/NETGEAR-48-Port-Gigabit-Ethernet-Managed/dp/B0015W5M12?source=ps-sl-shoppingads-lpcontext&ref=fplfs&psc=1&smid=ATVPDKIKX0DER	https://www.amazon.com/Cat5e-Ethernet-Cat-5e-VIVO-CABLE-V013/dp/B00O82K74K?source=ps-sl-shoppingads-lpcontext&ref=fplfs&smid=A3W3S2WCK1O3NR&th=1 250 ft = 76.2m	https://www.amazon.com/BOPLAT-Port-Cat5e-Ethernet-Plate/dp/B08Y7VPTZ8/ref=sr_1_5?crid=7QM0B636GU3S&keywords=cat+5e+outlet+face&qid=1695935663&s=electronics&prefix=cat+5e+outlet+face%2Celectronics%2C91&sr=1-5	https://www.avfirewalls.com/FortiGate-100F.asp
Cost Per Material	24.99	369.99	29.99	6.59	2,211.30
# of materials	8	4	84(+10%)	148(+10%)	1
Cost	\$200	\$1480	\$2,519	\$975	\$2,212
Total Cost:	\$7,386				



Network Diagram

